

C:\Users\NH103644\WSP\0365\Kurup, Rohul - 70131359-001-70101676-002-ICRC Lot A WA181193W Cycle Parking Stands\Feasibility\Midhuna\70101676-WSP-P01-X-DR-HI-0100.dwg 17 Feb, 2023 - 12:23pm

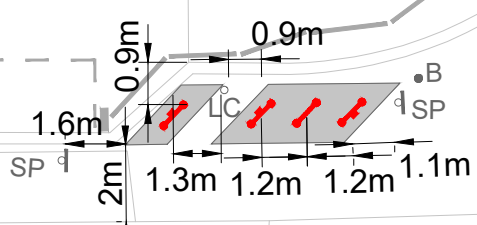
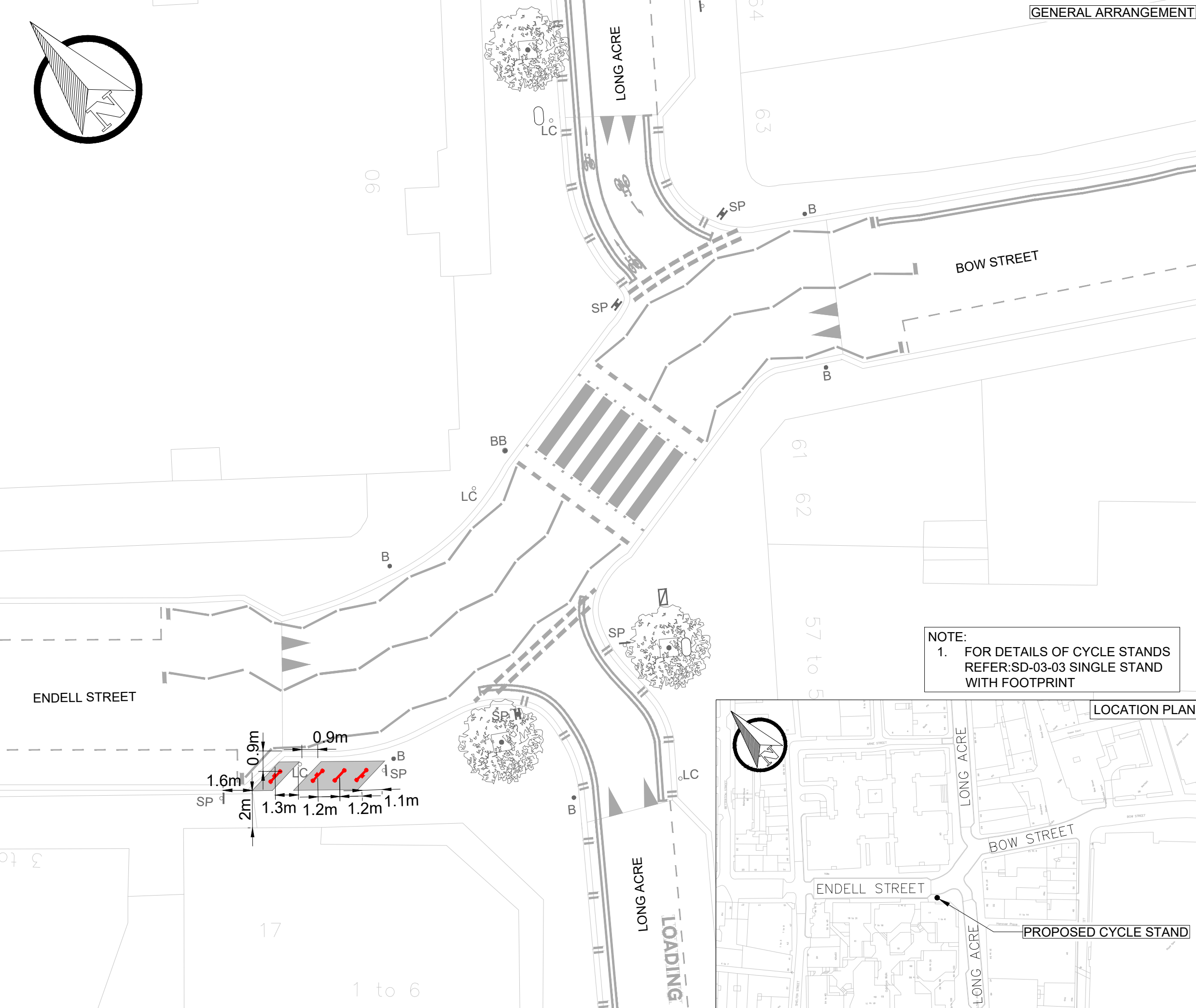
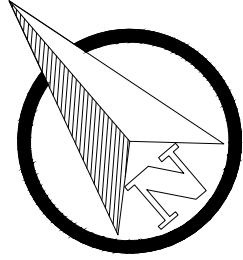

**GENERAL ARRANGEMENT**

KEY	
	EXISTING LINE MARKING
	EXISTING KERB
	EXISTING LAMP COLUMN
	EXISTING SIGN AND POST
	EXISTING SIGN AND POST (DOUBLE SIDED)
	EXISTING CANNON BOLLARD
	EXISTING BELISHA BEACON
	EXISTING LITTER BIN
	EXISTING UTILITY CABINET
	EXISTING TREE AND PIT
	PROPOSED TYPE 1 CYCLE STAND
	PROPOSED TYPE 2 CYCLE STAND
	PROPOSED CYCLE FOOTPRINT

REV	DATE	BY	DESCRIPTION	CHK	APD
S2-P01	15.02.2023	MM/HJ	INITIAL ISSUE	PV	DVR

DRAWING STATUS: **FEASIBILITY DESIGN**

25 Mandela Way, London, SE1 5SZ  
www.fmcgonway.co.uk www.wsp.com

**NOTE:**  
1. FOR DETAILS OF CYCLE STANDS REFER:SD-03-03 SINGLE STAND WITH FOOTPRINT

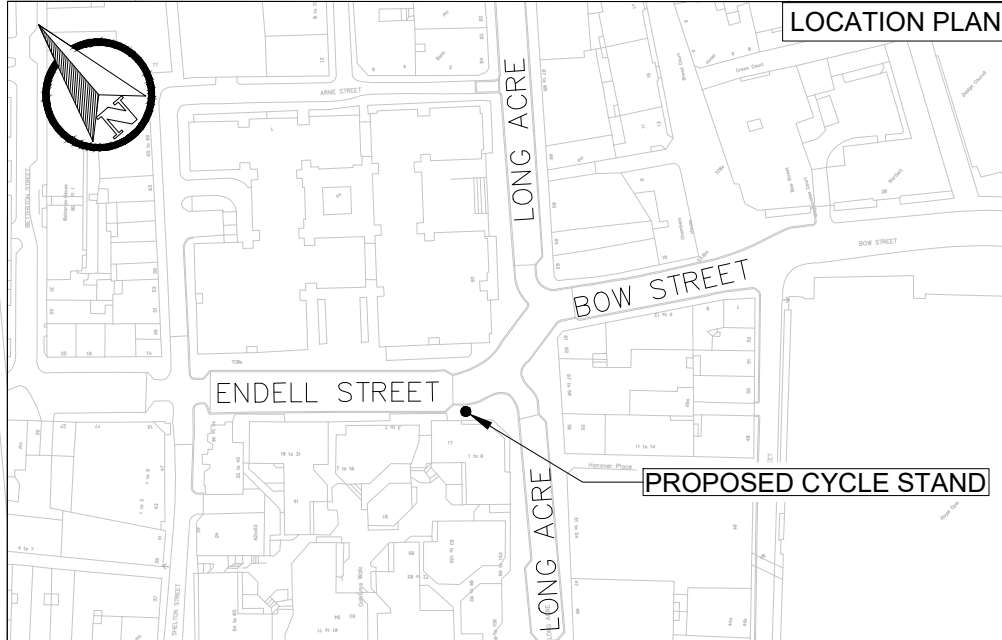

CLIENT

**City of Westminster**

PROJECT: **LOT A WA181193W Cycle Parking Stands**

TITLE: **2 ENDELL STREET GENERAL ARRANGEMENT**

SCALE @ A3	DATE	DESIGN/DRAWN	CHECKED	APPROVED	SHEET
1:200	15.02.2023	MM/HJ	PV	DVR	A3
WSP PROJECT NO.	FMC PROJECT NO.	WCC PROJECT NO.			
70101676	WA2209MCP	C.WD13413			
DRAWING No.	REV.				
70101676-WSP-P01-X-DR-HI-0100-05	S2-P01				