

\\uk.wspgroup.com\central_data\Projects\70103xxx\70103010 - Lot A WA2210H3C Cycle Parking Programme - Cycle hangars\02 WIP\HW Highways\01 Model\01-Feasibility\CAD\HU\1\70103010-WSP-P01-X-DR-HI-100.dwg 25 May, 2023 - 4:49pm

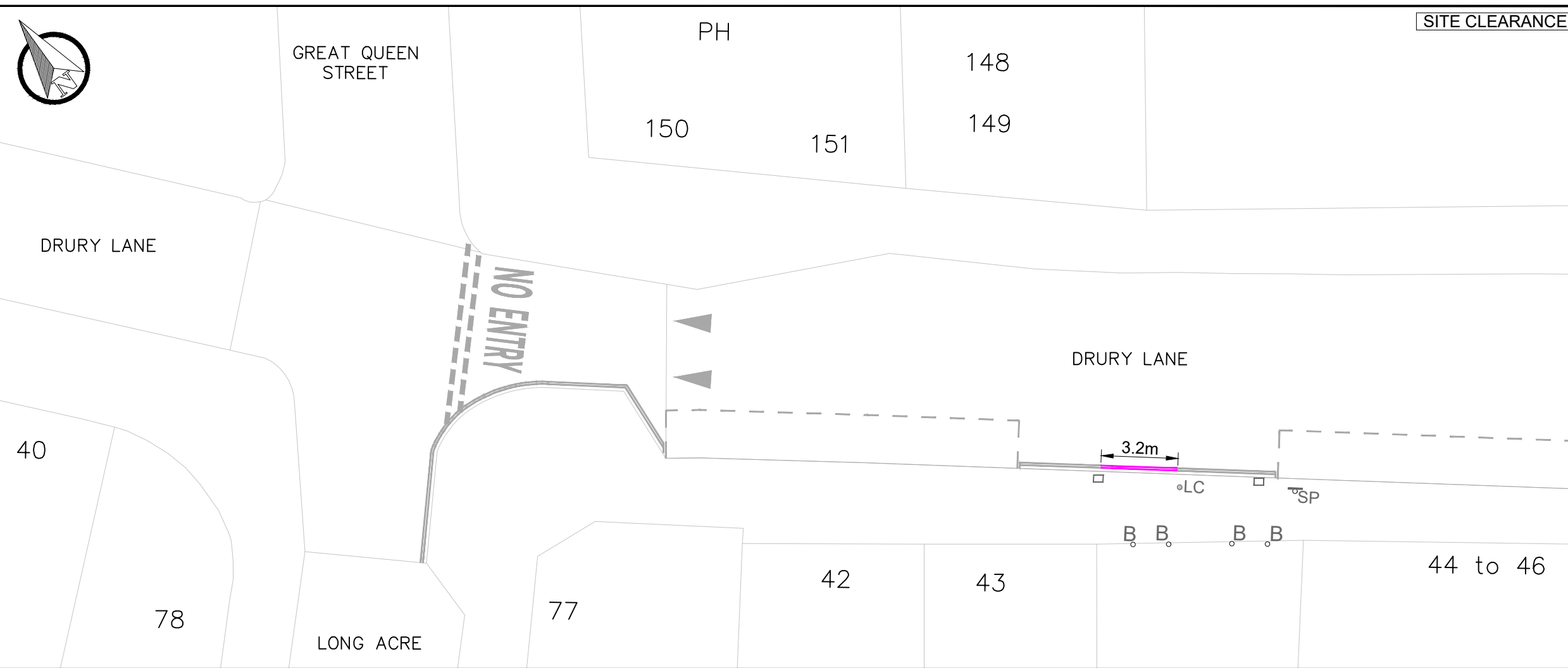

SITE CLEARANCE

- KEY**
- EXISTING LINE MARKING
 - EXISTING KERB
 - EXISTING SIGN AND POST
 - EXISTING ROAD MARKING TO BE REMOVED
 - PROPOSED CYCLE HANGAR (1 No.) (TO BE INSTALLED BY THIRD PARTY)
 - PROPOSED WHITE LINE MARKING
 - PROPOSED YELLOW LINE MARKING
 - EXISTING SERVICE COVER
 - EXISTING CANNON BOLLARD
 - EXISTING LAMP COLUMN

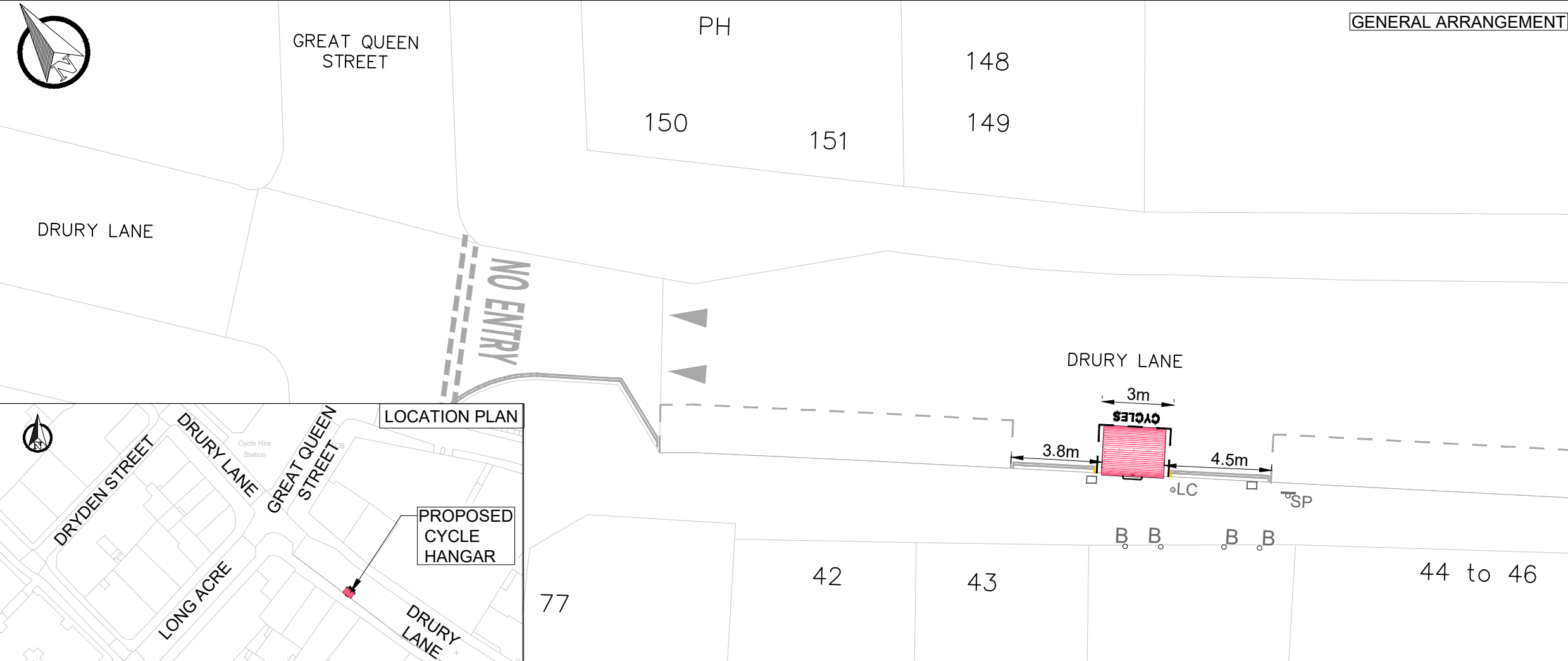

GENERAL ARRANGEMENT

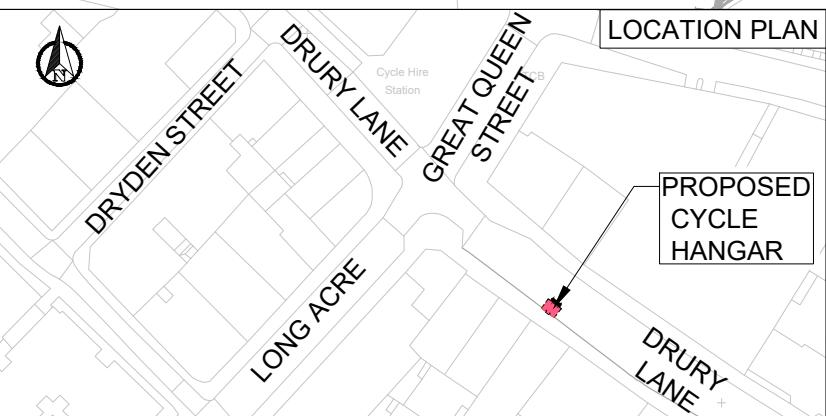

LOCATION PLAN

REV	DATE	BY	DESCRIPTION	CHK	APD
S2-P01	04-05-2023	HJ	INITIAL ISSUE	JAH	DVR

DRAWING STATUS
FEASIBILITY DESIGN



25 Mandela Way, London, SE1 5SZ
www.fmconway.co.uk www.wsp.com



PROJECT
CYCLE PARKING PROGRAMME - CYCLE HANGARS
2022-2023

TITLE
DRURY LANE
SITE CLEARANCE & GENERAL ARRANGEMENT

SCALE @ A3 1:200	DATE 04-05-2023	DESIGN/DRAWN HJ	CHECKED JAH	APPROVED DVR	SHEET A3
WSP PROJECT NO. 70103010	FMC PROJECT NO. WWESA3171	WCC PROJECT NO. C.WD13413			
DRAWING No. 70103010-WSP-P01-X-DR-HI-100-61	REV. S2-P01				